



UCEM Institutional Research Repository

| | |
|----------------------------|---|
| Title | Other People's Dreams |
| Author(s) | Lee Ivett and Ecaterina Stefanescu |
| ORCID | https://orcid.org/0000-0002-4287-6145 ; https://orcid.org/0009-0004-7047-7784 |
| Type | Conference or Workshop Item |
| Publication title | |
| Publisher | |
| ISSN/ ISBN | |
| Publication Date | 10 March 2025 |
| Version | |
| DOI | |
| Repository link | https://ube.repository.guildhe.ac.uk/id/eprint/233/ |
| Link to publication | |

Copyright:

UCEM aims to make research outputs available to a broader audience via its digital [Repository](#). Where copyright permits, full text material held in the Repository is made freely available. URLs from GuildHE Research Repositories may be freely distributed and linked to. Please refer to each manuscript for any further copyright restrictions.

Reuse:

Copies of full items can be used for personal research or study, educational, or not-for-profit purposes without prior permission or charge provided that the authors, title and full bibliographic details are credited, a hyperlink and/or URL is given for the original metadata page, and the content is not changed in any way.

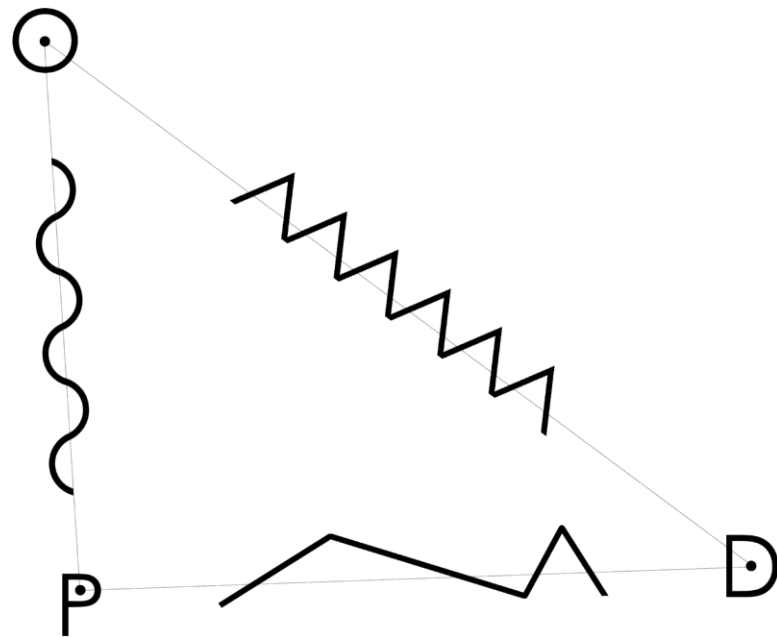

OTHER PEOPLE'S DREAMS

Lee Ivett + Ecaterina Stefanescu

//

participating with place — *learning through doing and thinking through making*

//

I'VE NEVER REALLY KNOWN HOW TO DO ANYTHING UNTIL AFTER I DID IT

//



_poster campaign

our first level of intervention takes the form of a poster campaign. On a primary and immediate level this type of intervention quickly effects peoples perceptions of space, environment and context

this is a quick and productive way to gauge interest in a particular issue and identify project partners



//

Observations of human behaviour as a means of identifying and communicating need

//

//

WHAT IS THE SMALLEST ACT THAT WE MIGHT TAKE IN ANY GIVEN SITUATION TO EFFECT A CHANGE?

HOW DOES THAT INITIAL SIMPLE AND RESPONSIVE ACT BECOME THE CATALYST FOR FURTHER ACTS OF INCREASING AMBITION, COMPLEXITY AND DURATIONAL IMPACT?

//



//

We value our ideas and our agency and appreciate how lucky we are to get to express them. Contemporary society is increasingly fearful of, ideas, agency and self-determination, and this is often reflected in the types of space and buildings that that we now create within and for our communities

//



//
Regeneration is rarely a regenerative act – it is often wilfully and celebratorily destructive, wiping the slate clean. The next big idea often
become the next failed utopia
//

//

If we can learn anything from the last 150 years of development in our collective built environment it should be that a generational and cyclical process of demolition and re-making, or ripping it up and starting again, doesn't lead to sustained and maintained changes in the wellbeing, empowerment and opportunities for those most marginalised and most peripheral within society.

How is it then that we can conceive and propose new infrastructures of place that ensure that renewal and repair is a holistic, organic and responsive component of everyday life, one that is conceived and enacted by the people of that place?

How can the potential and the necessity for sustainable and sustained change be identified, actioned and manifested by those that reside and work within the place itself, rather than be imposed by those out-with and for the economic benefit and empowerment of peoples, institutions and other actors unseen and remote from the place itself.

In other words, rather than 'Place-making' - the soft power, supposedly people-friendly first responder of neo-liberal 'regeneration' - how might we instigate a new condition of '**place making place**' where communities are empowered to establish a social and cultural condition of constant learning, evolving and repairing as an inherent experience of daily life.

//



//

Despite a growing appreciation of the role of participation and ‘co-production’ within community art, architecture and design these processes are often applied to places, with people being compelled or encouraged to participate in the work rather than the work participate in the place.

Community consultation increasingly adopts processes and attitudes which appear to emotionally coerce members of the public into providing information and knowledge through obscure exercises in mapping, game playing, post-it-notes and questionnaires, later to be disseminated back to the community by community engagement professionals as banal phrases and pithy hashtags.

Instead of learning within the context of the contrived realities of contemporary participatory practice – through an enforced collection of words, pictures, phrases, sketches – we believe in a process of **participating in many aspects of a place through the act of making** to create an embedded and responsive process of critical and creative enquiry.

Participation as a continuous, situated and durational process of **reciprocal learning and knowledge exchange**.

//



//

Richard Sennet talks about the “evolutionary dialogue between the hand and the brain” (2009, 151). He writes that the information received through the hands is richer, more sensate than through the eye, and argues for the tacit knowledge created by “hand habits” (Sennett, 2009, 10).

Through the act of making, anthropologist Tim Ingold argues that the Maker at once exists as observer and participant, and there is no differentiation between implicit knowledge and told, articulated knowledge. Through practice and experience, the transfer of knowledge between the different actors involved in this process takes place and the Maker, through the vector of the thing they create, simultaneously observes, documents and analyses (Ingold, 2013).

In the same way that Richard Sennet and Tim Ingold articulate the potential, through making, for the individual to gain knowledge and insight, communities of people and place might collectively acquire and retain knowledge through shared, collaborative, situated and participatory making.

The act of making is then both representational and interventional, and as such becomes transitional, offering a means of suggesting and testing new possibilities which are generated by the very people of that place.

Making is re-positioned not as a finite act, but as a series of empathic and responsive actions that situate the researcher/maker within the physical, cultural and social conditions of ordinary life.

//

//

Beith 2012 - 2025

//

Prototype – Place – Permanence



Key

Routes + Trails

- Railway Line
- All Roads/Major Paths
- Country Trail
- Town + Heritage Trail
- Loch Trail

Landmarks

- a. Spier's Old School Grounds
- b. Geilsland School
- c. Beith Primary School
- d. Beith High Church
- e. Auld Kirk
- f. Willowyard Estate
- g. Kilbirnie Loch
- h. Golf Course
- i. Whisky Bond

DEVELOPMENT PROCESS



A - RESEARCH: conditions of the town are thoroughly researched, recorded and analysed



B - OBSERVATION: the nature + character of the town is observed + recorded



C - ENGAGEMENT: our observations tested through engagement + consultation



D - DESIGN: ideas sketched out and presented through models and drawings

BEITH DEVELOPMENT STRATEGY



all of the ideas presented respond directly to the comments, thoughts and suggestions of local people

BAXENDALE

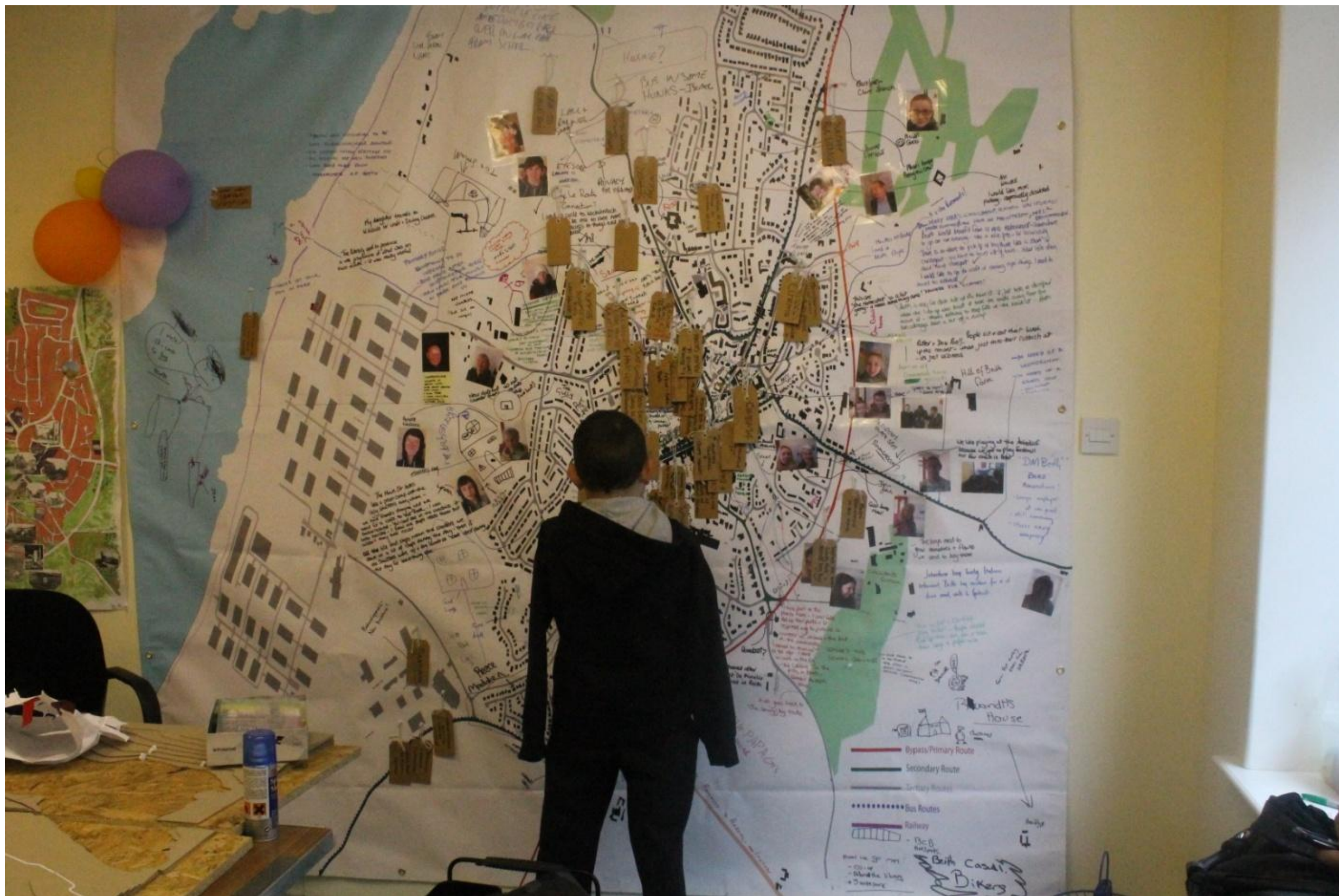





Thursday 30th January
School Night Favourite
Come along and share a quick and tasty dish that you love and is quick and easy enough to make after a busy day.

Thursday 27th February
Sexd Veggie
Do you have a veggie recipe you love to make for your loved one? Share your love for it tonight.

Thursday 27th March
From your Travels
What's the dish that will take you right back? (To old pub in Dunkeld, beach in Egypt, Swiss mountains, aunties kitchen...everything counts)

7pm - 9pm



Kicks off at 12.30pm

The Corey cup is to be an annual football tournament held at Bath Astro for all primary schools within the Garmock Valley in memory of Corey Hamilton. The winning team will receive an engraved silver trophy.
Monday 24th March

Join us as we create some wonderful recycled crafts, let the kids enjoy tyre-dyeing and potatoe printing at our famous Crafternoons.

Saturday 1st February
Saturday 22nd February
Saturday 29th March

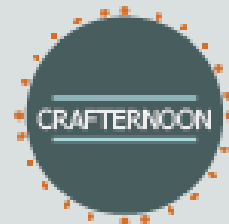

11am - 3pm



Need a new pair of jeans or a new jacket to keep you cosy in the approaching Scottish Spring, well pop along and take advantage of our free Swap Shop.

Saturday 8th February
10am - 4pm
Sunday 9th February
1pm - 4pm



Monday 17th - Saturday 22nd March
12pm - 4pm

A whole week dedicated to Garmock Valley's own young artists and creative masters.
Please join us to celebrate the work of these from primary to secondary school.

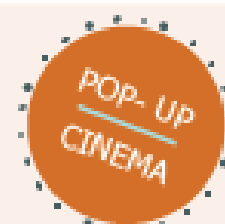

6pm - 8pm

Bring the whole family along to enjoy a movie, popcorn and sweeties together in our candlelit cinema. A fun filled evening for free!

Friday 31st January
Friday 14th February
Friday 28th February
Friday 14th March
Friday 28th March



12pm - 4pm

A charity relay event with a spin. Begin your mission at POP-UP Bath on our spin bikes then head to Curves Gym to finish off the challenge. All proceeds go to securing a defibrillator for the community of Bath. Get your valentine's heart pumping for a good cause. Contact us now to book your place.



Thursday 6th March
Friday 7th March
Saturday 8th March
10am - 5pm

Do you want to pick up a few tips on saving fuel whilst driving? Well POP-UP Bath will have an eco-driving simulator, fuel efficient driver trainers and an electric vehicle for you to try out and learn from. Along with energy efficiency experts helping you save cash elsewhere too.



11am - 3pm

What better way to entertain the kids on a school holiday than letting us keep them busy with an extra special Crafternoon.

Friday 7th February
Monday 10th February
Tuesday 11th February



Pancake day is a tradition that the whole family loves, we will be celebrating with a little flip on the tradition by making our pancakes with just a candle and tin can. Both children and the young at heart are welcome.







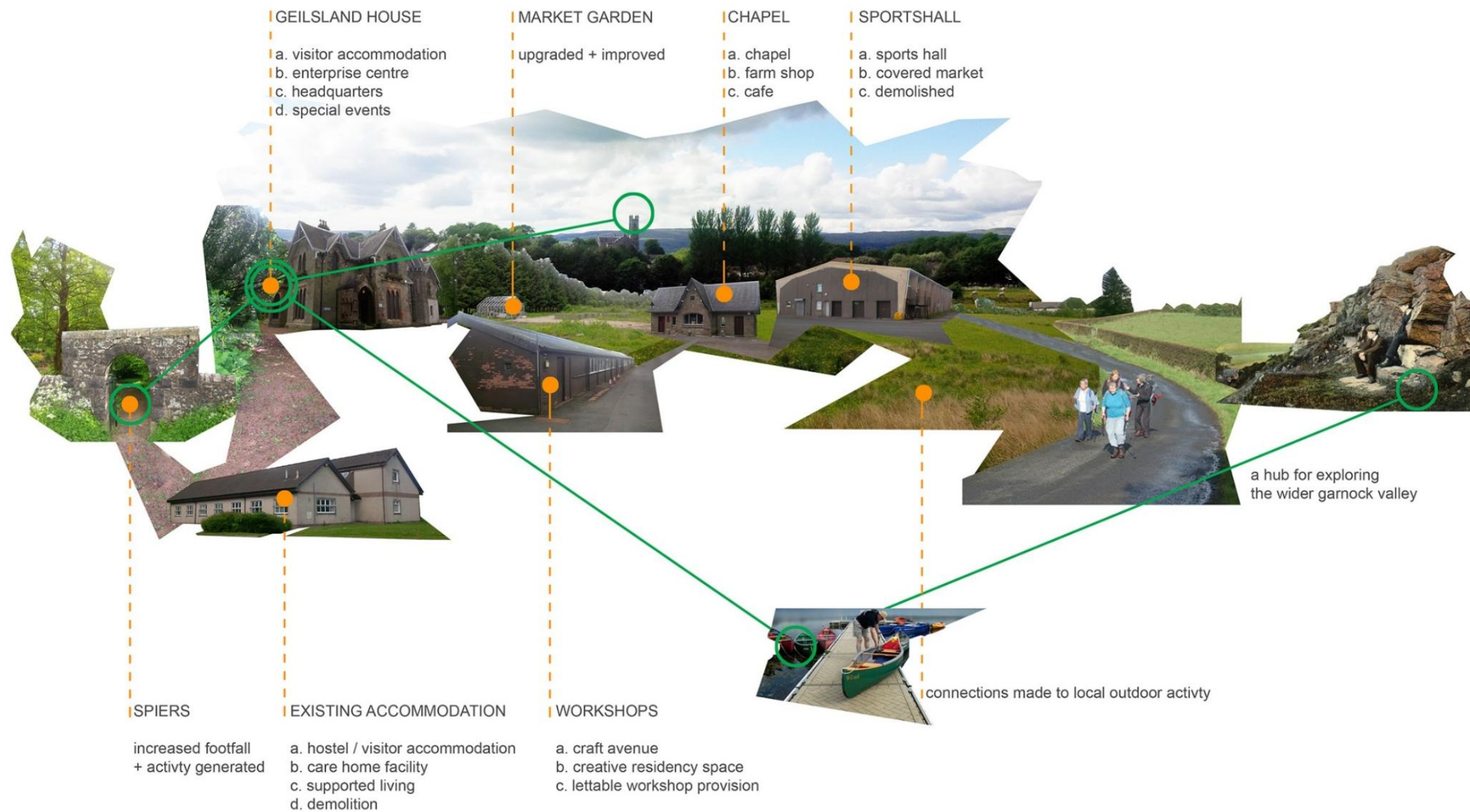

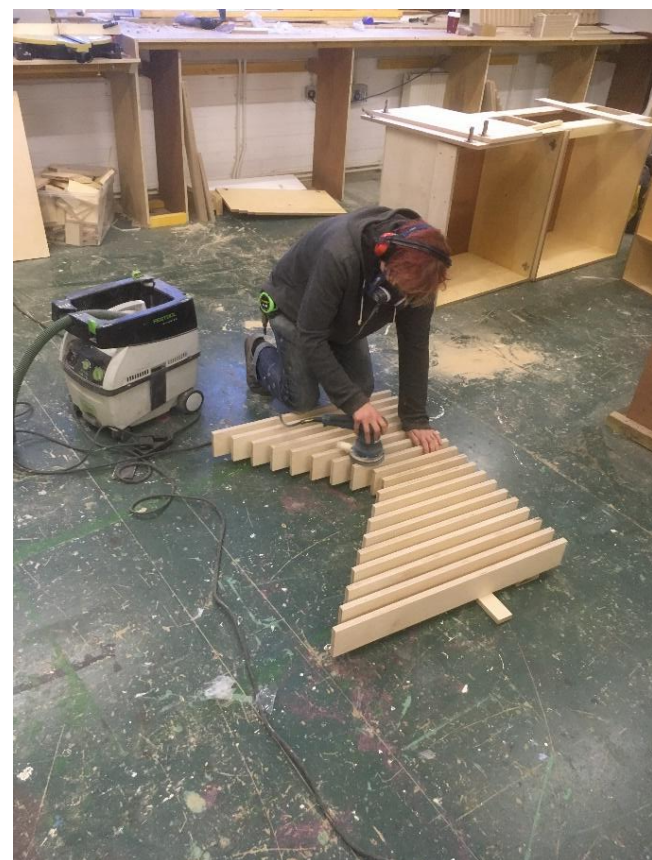



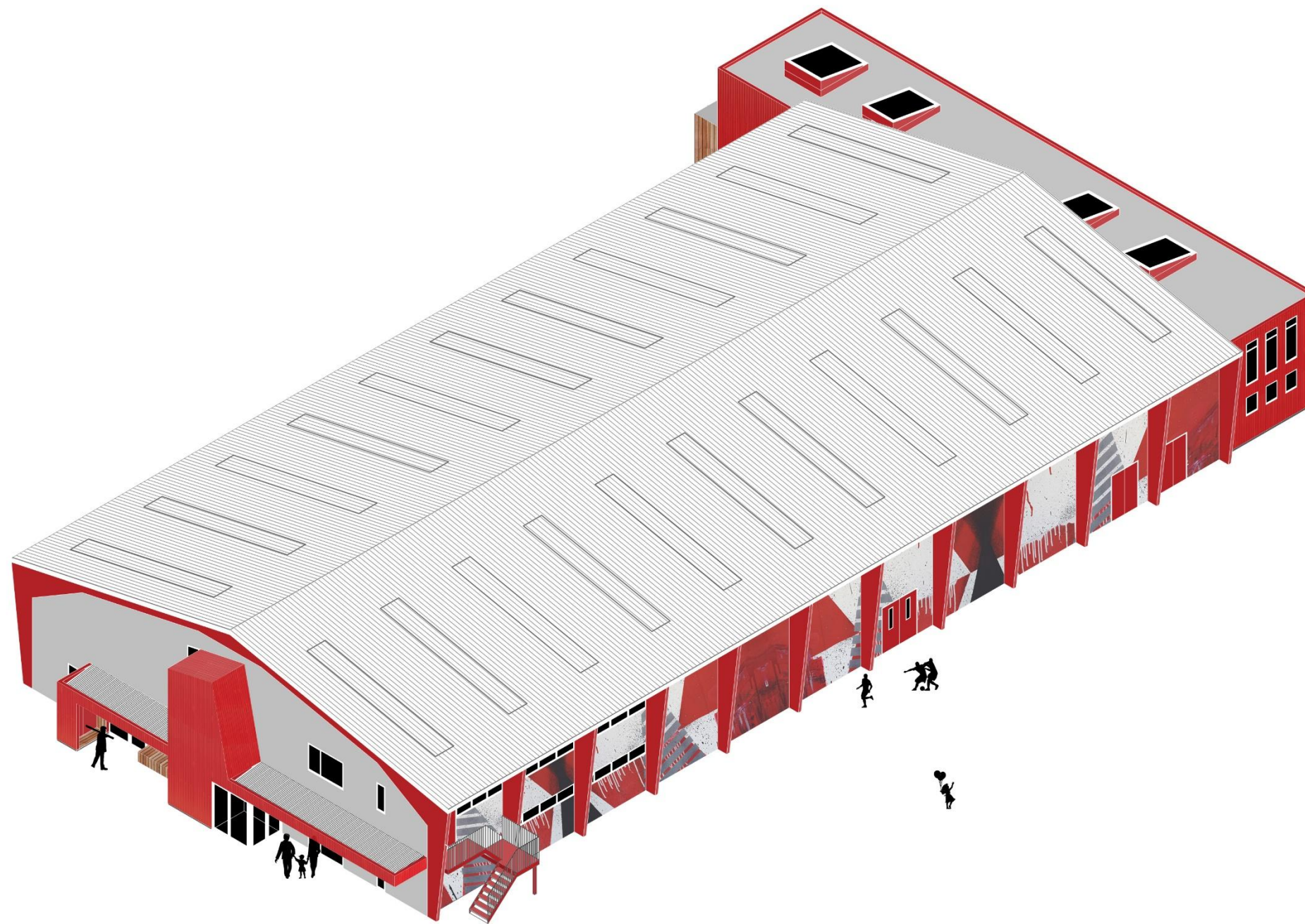

1.2.1



[Home](#)

[Find out more](#)

[What we do](#)

[Our Projects](#)

[News and Events](#)

[Blog](#)

[Get Involved](#)

[Contact Us](#)



BY AND FOR THE PEOPLE OF BEITH

A thriving community and a flourishing place.

GET INVOLVED



[Event Calendar](#)[Geilsland Cottages](#)[Corporate Days at Geilsland Estate](#)[Hen, Stag, & Sten Weekends](#)[Wedding Packages](#)[Book a Space](#)[Businesses at Geilsland](#)[Contact Us](#)

GEILSLAND ESTATE

A stunning destination for all your life celebrations, festivals, community and enterprise events.

[VIEW OUR SPACES](#)



//

The Happenstance: Venice Biennale - 2018

//

Practice becomes research





//

Ethnographic modelmaking

//

Documenting, analysing and revealing the value of everyday spaces through modelmaking



Rooms



Berlin, 2021-22 (as Estudio ESSE)
Urban National Museum Art Residency



//

Using models as a slow, durational ethnographic method encourages a deeper level of observation, exploration and community engagement, and fosters a profound connection between the maker, the subject of research or the site of co-production.

//



Other People's Dreams

OPD was originally established within the Grenfell-Baines Institute of Architecture and operates simultaneously as a live action research office and Master of Architecture course. OPD engages in a critical and durational way with community organisations in the northwest region, exploring modes of participation with marginalised groups, situations and ideas in order to rethink the potential of people and place. We explore that which is often 'unseen' within architectural education and practice: everyday life as experienced by everyday people, born and often made peripheral through birth, migration and circumstance.

We re-evaluate the concept of an architect as facilitator for other people's dreams. We question what it is to dream and to what extent our individual aspirations and dreams align with collective need and desire?

OPD currently comprises of architects, designers and academics Lee Ivett, Ecaterina Stefanescu and Sam Eadington.

Over the past 5 years, OPD has been developing strategic and impactful relationships with the following third sector community arts organisations:

LeftCoast (Blackpool)

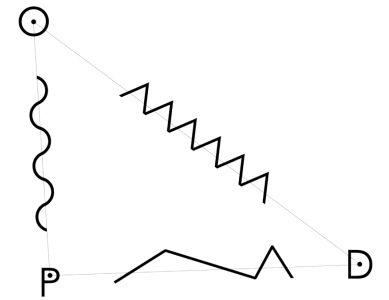

Super Slow Way (Blackburn)



Grizedale Arts (Crake Valley)



Glassball Studio (Skelmersdale)



These relationships and projects also now align with and inform our Master of Architecture courses:

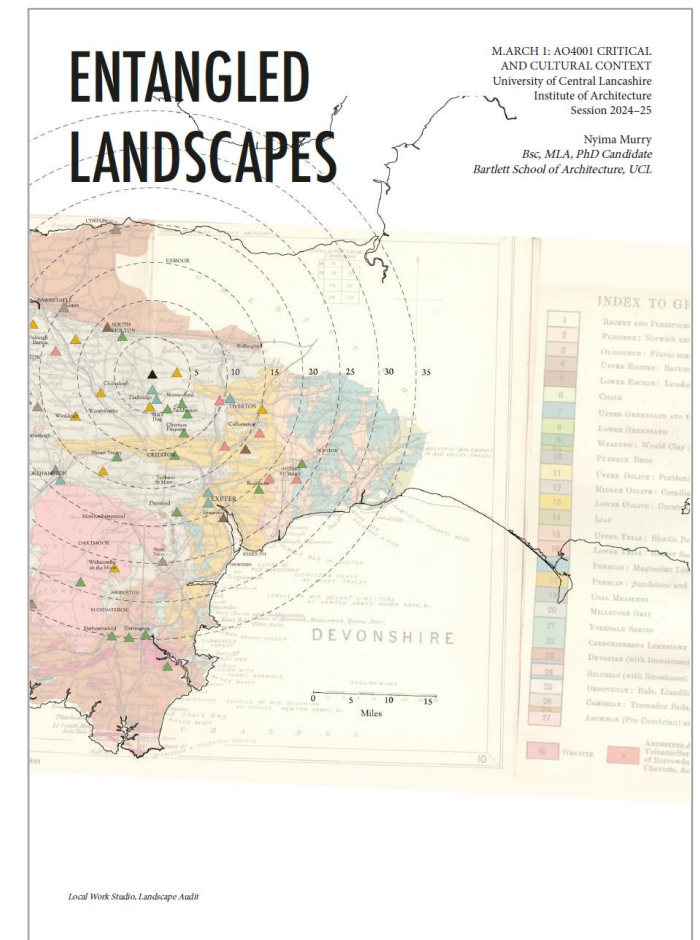
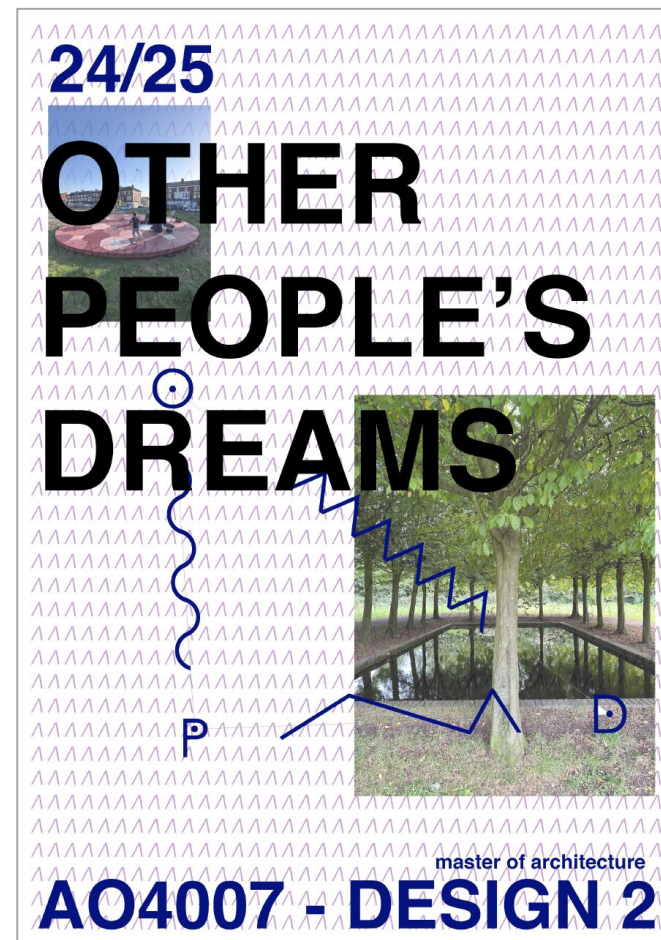

Module briefs situated in the collaborative communities



//

Blackpool 2021 - 2025

//

Prototyping and challenging typologies of community infrastructure



Wash Your Words - Langdale Library and Laundry Room

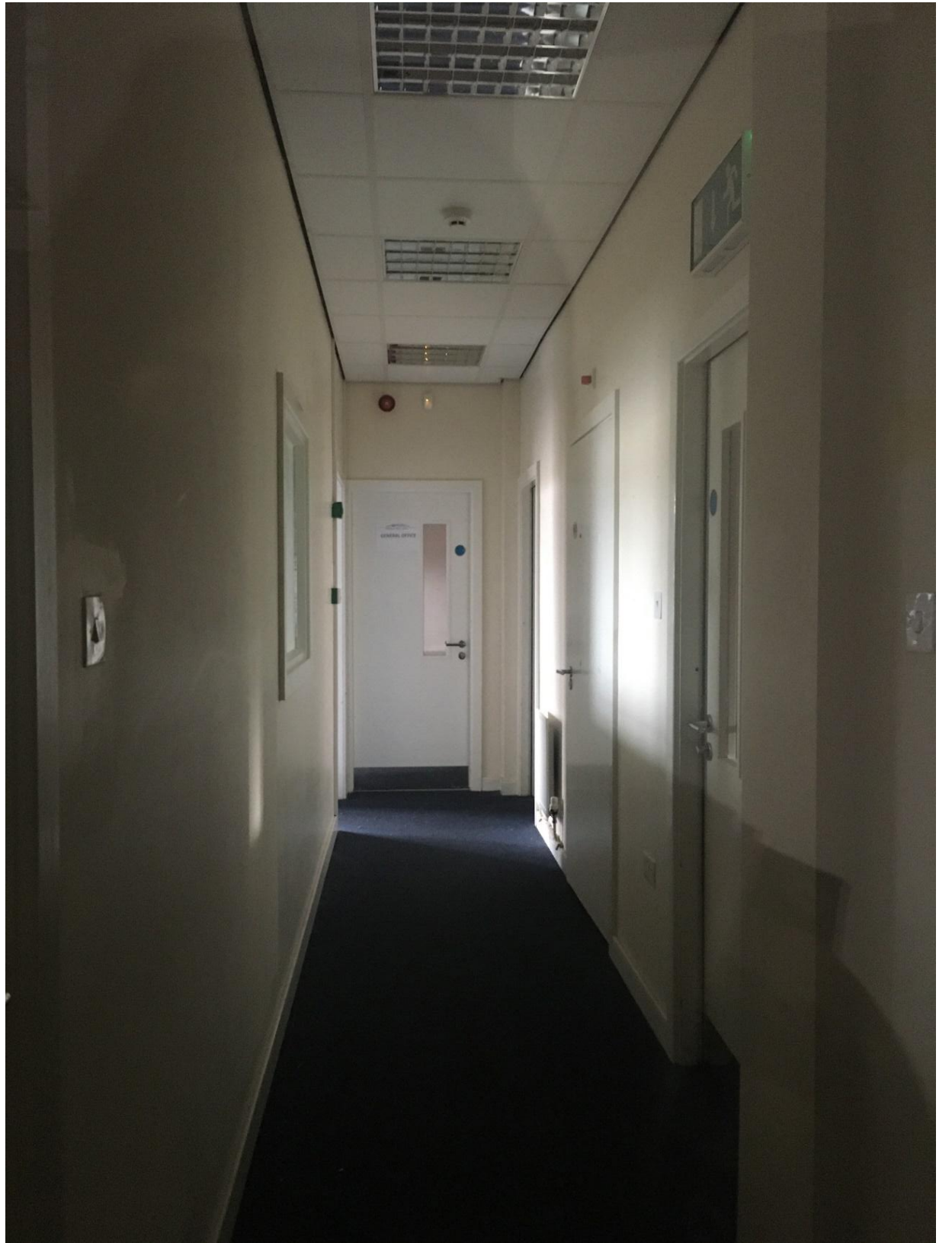

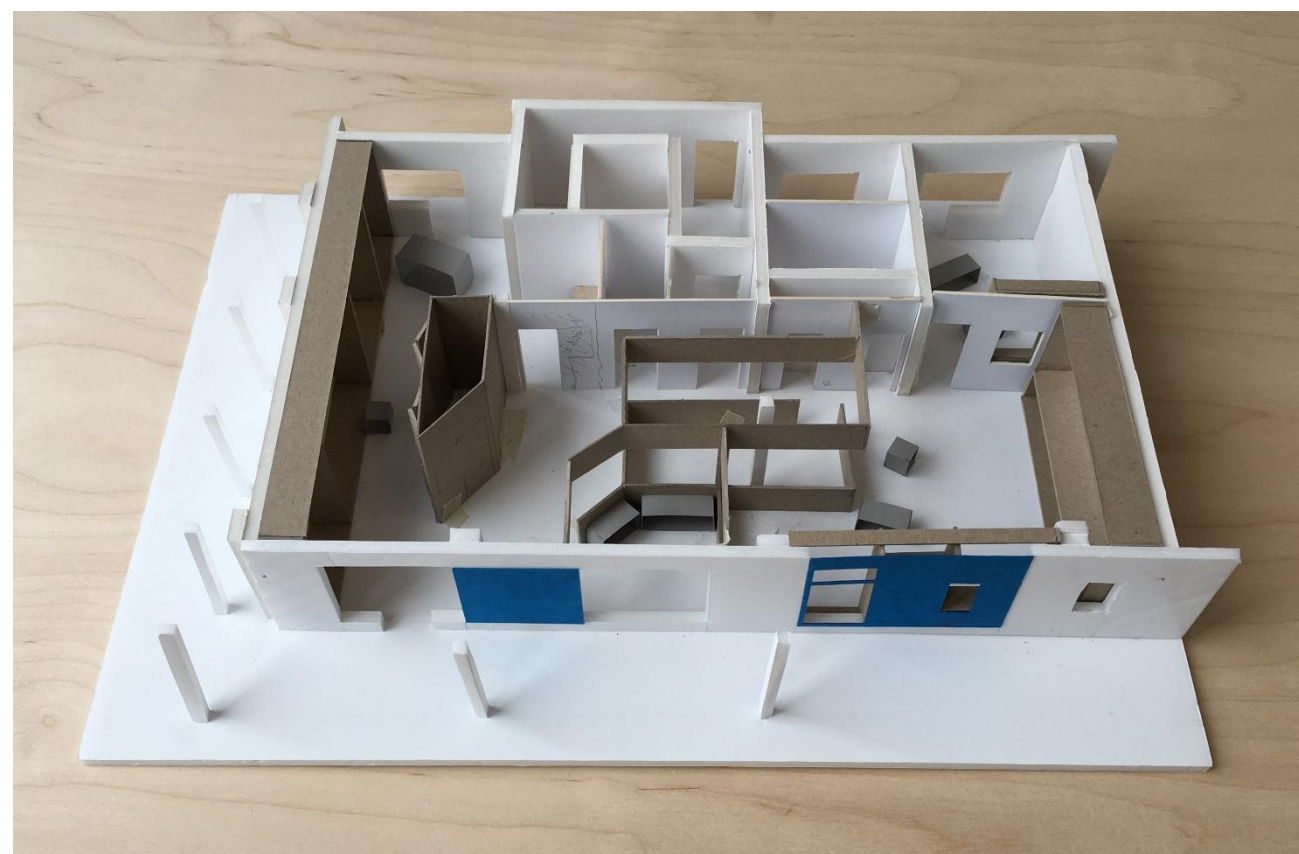
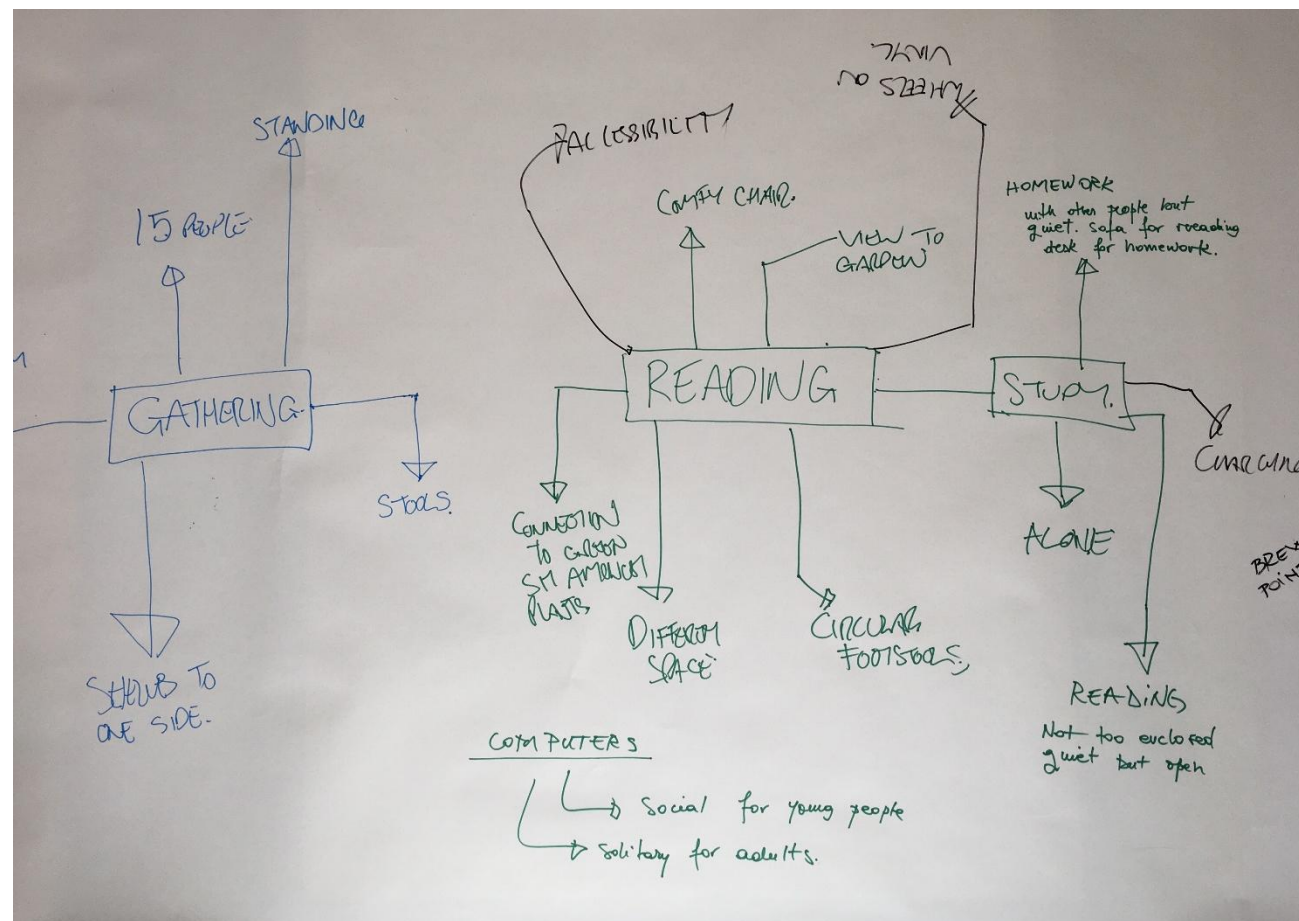









BBC

Your account

Home

News

Sport

Weather

iPlayer

Sounds

Bitesize

...

Search BBC

NEWS

Home

Cost of Living

War in Ukraine

Coronavirus

Climate

UK

World

Business

Politics

Tech

England | Local News | Regions | Lancashire

Blackpool library and laundry room shortlisted for RIBA award

18 January



CLAIRES GRIFITHS

Judges described Wash Your Words as a "joyful design" which "raised expectations"

Top Stories

Dozens of migrants killed in shipwreck off Italy

1 hour ago

Sunak 'giving it everything' to get NI Brexit deal done

52 minutes ago

LIVE Progress made on NI Brexit deal, says Raab

4 hours ago

Features



The story of Scottish independence - what next?

Lancashire NewsBlackpool

Unique Blackpool community project combining reading and laundry

Wash Your Words at the Langdale Library and Laundry Room on Mereside is in the running for the RIBA (Royal Institute of British Architects) Journal's MacEwen Award

NEWSBy Shelagh ParkinsonLocal democracy reporter05:00, 22 JAN 2023

Bookmark

Facebook

Twitter

LinkedIn

Comments

Enter your postcode for local news and info

Enter your postcode

Go

In YourArea



MOST READ

1



Nicola Bulley TikTok ghoul who tricked police to covertly film mum's body being removed from river unmasked

2



Manchester Airport issues warning over action that could see travellers holidays "ruined"

3



Noel Radford asks 'is it time to retire?' as Sue expresses family

The Gazette

News you can trust since 1873

10 pictures as pupils take first look inside development set to take Lytham St Annes High School into a new era

World Book Day across

The community building on Langdale Parade was praised for its 'joyful design' and said it raises expectations of the quality of architecture people should demand of social housing estates.



RIBAThe RIBA Journal

Design in the making

Subscribe

Login

Buildings

Intelligence

Culture

Learning

Products

Explore

Jobs

Buildings

MacEwen Award 2023

MacEwen Award 2023 commended: Wash your Words adds books to chores







Visit to Wharf Building, UCLan
November 2022

Buildings
MacEwen Award
2023

MacEwen Award 2023 commended: Wash your Words adds books to chores



In numbers

Total budget £30,000

Internal floor area 130m²

Cost per m² £231

Credits

Client LeftCoast

Architect Lee Ivett and Ecaterina
Stefanescu Grenfell-Baines Institute of
Architecture, UCLan

Partners Blackpool Council Libraries,
Blackpool Coastal Housing

Graphic designer Dan Astbury



Revoe: Modelling Migrancy and Community



Models created with the Romanian community during engagement workshops



MacEwen Award 2025 commended: Blackpool's Revoe Public Square



27 January 2025

Words: Flo Armitage-Hookes

The square, co-conceived, designed and constructed by residents, is fostering collaboration, agency and hopes for the future in an area facing deprivation

'Apart from the tower, there's nothing touristy about this part of Blackpool,' explains Lee Ivett, who runs University of Central Lancashire's live-action studio Other People's Dreams. Although the iconic tower peeks over rooftops in the Revoe neighbourhood, the leisure industry and seafront are a world away. The area faces significant deprivation, has few green spaces and is home to a range of disparate communities.

Until recently, a fenced-off wasteland lined the high street, following demolition in 2020 of the George Hotel pub – 'a rough but loved establishment'. Pressure to transform and open up the space was growing. Today, a new temporary public square on the site, co-conceived, designed and constructed by residents, is fostering collaboration, agency and hopes for the future.

Most popular

- 1 Rising Stars 2025: meet the shortlist
- 2 Sanei + Hopkins' Housestead: rigorous and refined, yet right...
- 3 Diplomatic framework: how London's hulking former US Embassy...
- 4 The new benchmark for low carbon concrete
- 5 Stirling Prize 2025 shortlist: the six

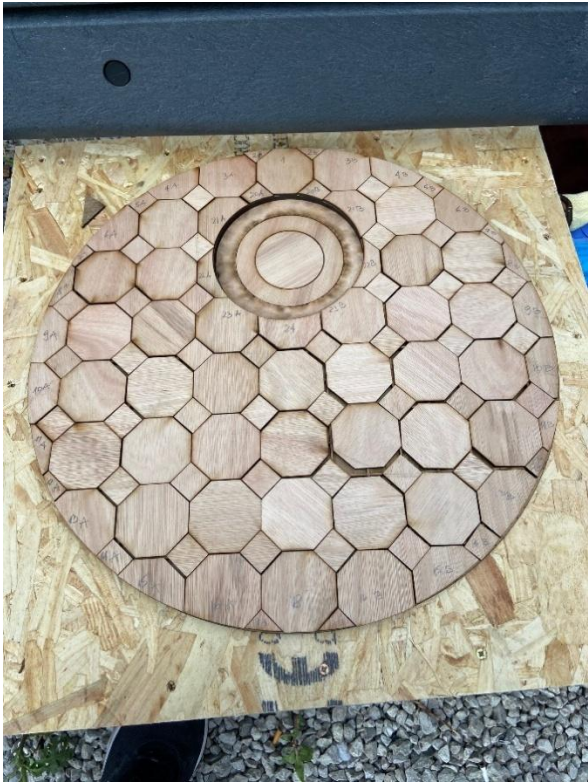

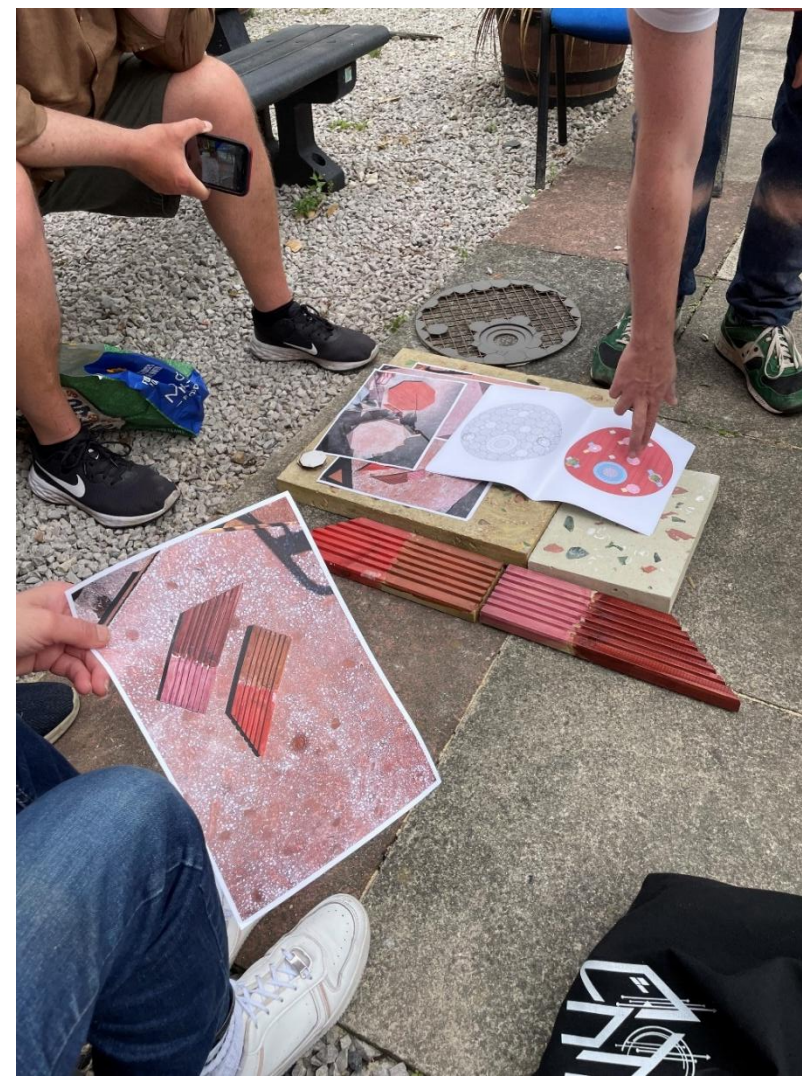

“simple acts of collaborative making bringing people together through shared objectives”



Square terrazzo tiles being made on site with members of the community, including the local Romanian Roma families and asylum seekers currently placed in the former Metropole Hotel on Blackpool's promenade. The community centre back garden is transformed into a casting and wood workshop.







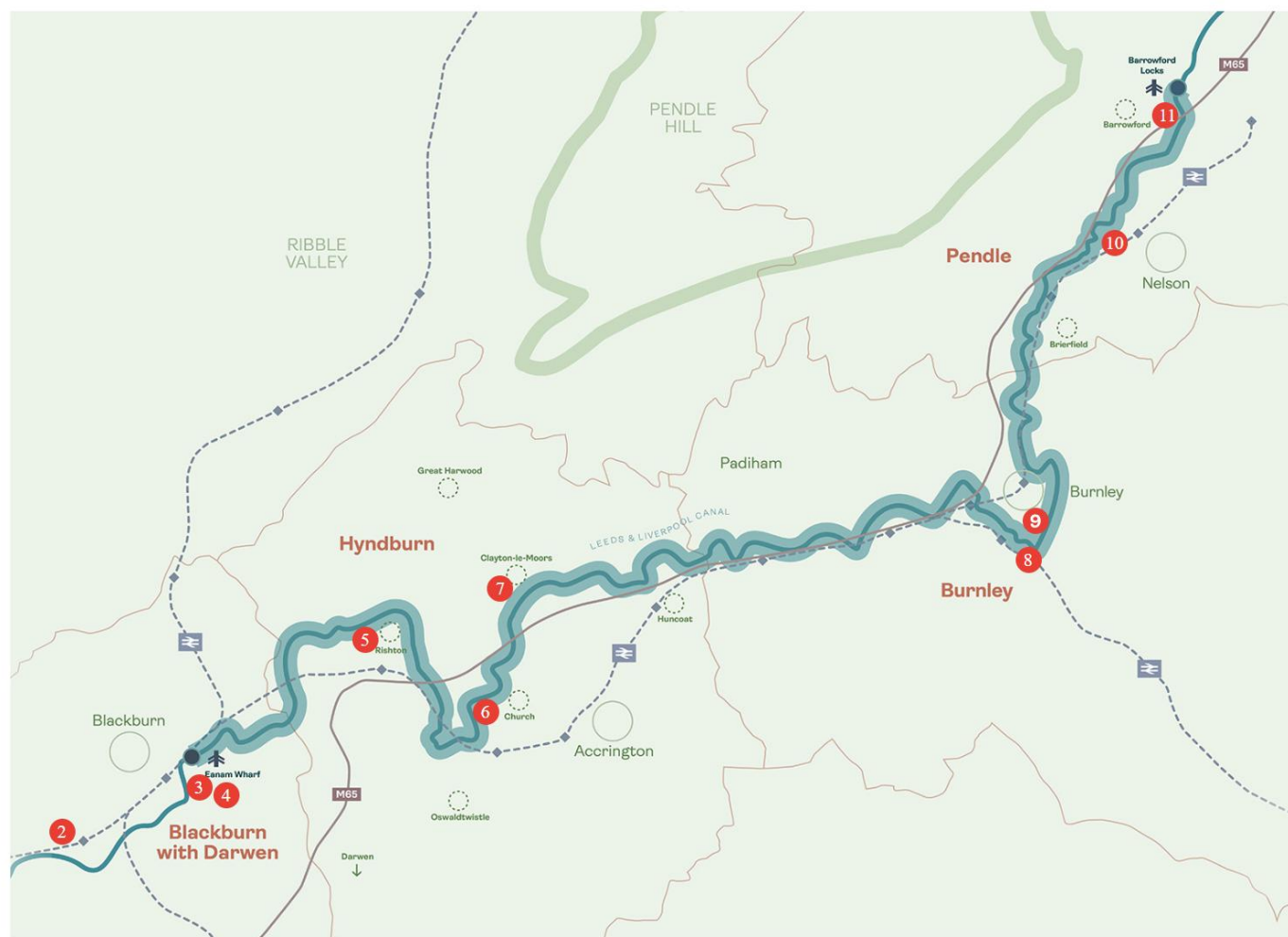

//

The Super Slow Way 2023 - 2025

//







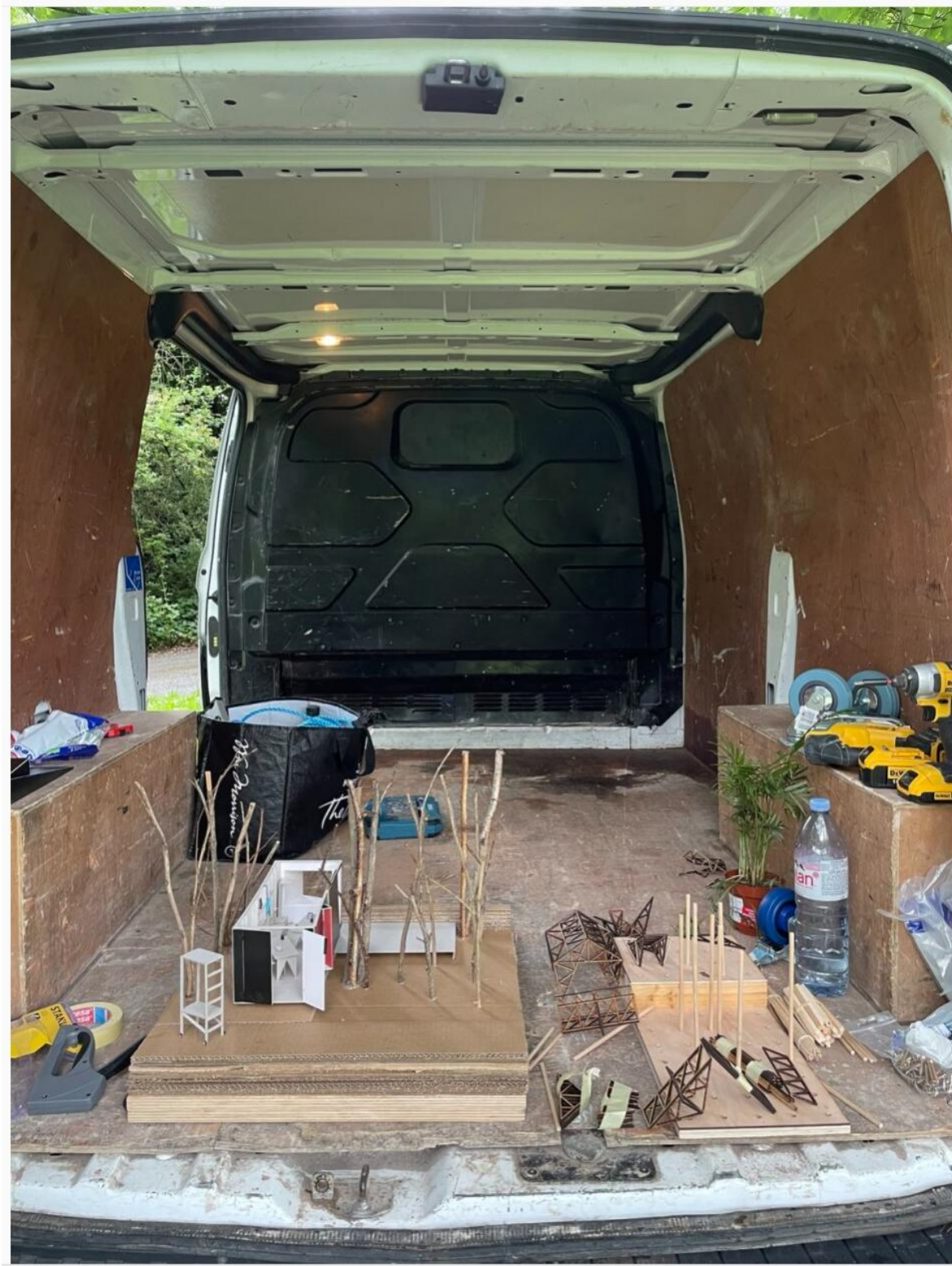













DRIFT: Bill Hunt Barge Community Radio

Blackburn, 2024 (Estudio ESSE & Super Slow Way)



DRIFT On Tour: Community Pop-up Radio Station
Blackburn, Nelson, 2025 (with Super Slow Way)





//

Prototyping ideas in public space to inform sustainable community led and community owned processes of 'regeneration'

Incrementally developing local knowledge, agency and capacity through acts of making: making events, making things, making places. Thinking through making and Learning through doing

Building capacity and agency; utilising the act of making and producing both place and programme as a tool for developing local empowerment and transferring knowledge and skills

Making EXISTING culture, people and education the foundation upon which regenerative strategies and conceived and enacted

Considering what is already there as the resource from which a progressive, gradual and sustained change might occur

An interdisciplinary approach to regeneration through the simultaneous development of both programme and place; transforming economy, culture and community

Sustainability by connecting people with place. A wealth of knowledge, resources, actions, capacity, ideas, agency actions and opportunity

//